

SHIRANA SHAHBAZI
Objects in Mirror
Are Closer than They Appear
 7 June – 26 August 2018

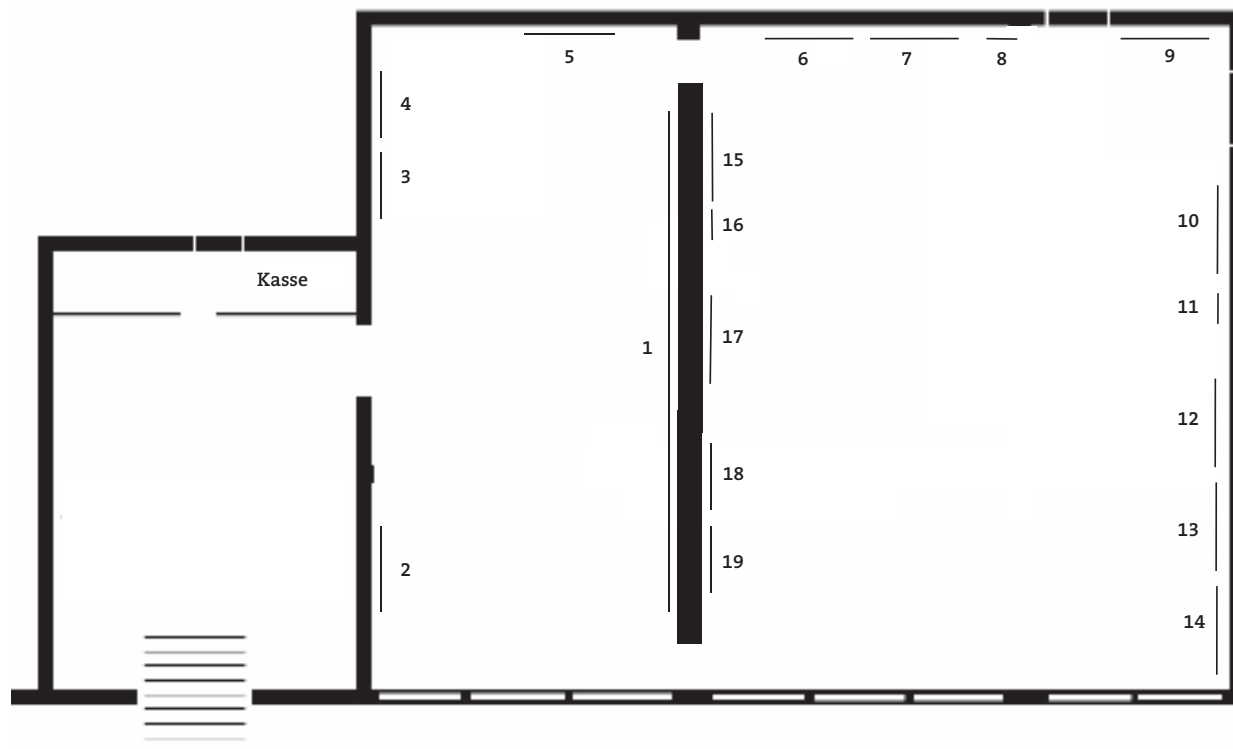

1
Tehran North, 2015–2017
 Lithography on Buetten
 Paper

2
Val-Madris, 2014
 Silver gelatine print on
 baryt paper

3
Muster-01, 2017
 Silver gelatine print on
 baryt paper

4
Raum-Blau-02, 2017
 C-print on aluminium

5
Muster-04, 2017
 Silver gelatine print on
 baryt paper

6
L.A. & Kirishima, 2018
 Silkscreen print

7
Ishigaki & Istanbul, 2018
 Silkscreen print

8
Raum-Grün-01, 2017
 C-print on aluminium

9
Plitvica & Caldas, 2018
 Silkscreen print

10
Raum-Rot-01, 2017
 C-print on aluminium

11
Raum-S/W-02, 2017
 Silver gelatine print on
 baryt paper

12
Kashan & L.A., 2018
 Silkscreen print

13
Plitvica & Erzurum, 2018
 Silkscreen print

14
Istanbul & Kars, 2018
 Silkscreen print

15
Raum-Blau-01, 2017
 C-print on aluminium

16
Raum-S/W-01, 2017
 Silver gelatine print on
 baryt paper

17
Caldas & Ishigaki, 2018
 Silkscreen print

18
Raum-Rot-02, 2017
 C-print on aluminium

19
Raum-Gelb-01, 2017
 C-print on aluminium