

The approach

20 Years Show

6th July – 6th August 2017

The Approach is pleased to announce a group show of gallery artists to celebrate our 20th anniversary. The exhibition will be installed in The Approach's original space above The Approach Tavern in Bethnal Green and includes works by:

Phillip Allen
Helene Appel
Sara Barker
Heidi Bucher
Sophie Bueno-Boutellier
Patrick Caulfield
Stuart Cumberland
Peter Davies
Patrick Hill
Evan Holloway
Allison Katz
Germaine Kruij
Rezi van Lankveld
Jack Lavender
Bill Lynch
Dave Muller
Lisa Oppenheim
Magali Reus
Amanda Ross-Ho
John Stezaker
Evren Tekinoktay
Sara VanDerBeek
Gary Webb
Sam Windett

The viewing room across the walkway will be showing archive film footage and images of shows we have presented over the last 20 years at The Approach E2 and W1 spaces as well as The Reliance in Shoreditch. Shows have included works by:

Michele Abeles; Gabriel Acevedo Velarde; Nick Ackerman; Haluk Akakçe; Phillip Akkerman; Ricci Albenda; Anni Albers; Phillip Allen; Darren Almond; Tariq Alvi; Mamma Anderson; Helene Appel; Nabuyoshi Araki; Liz Arnold; Frank Auerbach; Lisa Anne Auerbach; Nick Bailey; Olga Balema; Nono Bandera; Fiona Banner; Sara Barker; Phylis Barron & Dorothy Larcher; Jordan Baseman; Florian Baudrexel; Dirk Bell; Vanessa Bell; Hans Bellmer; Manfredi Beninati; Eva Berendes; Forrest Bess; Alexandra Bircken; Henning Bohl; Rutherford Boyd; Matthew Brannon; Ian Breakwell; Cris Brodahl; Vittorio Brodmann; Gavin Brown; Glenn Brown; Heidi Bucher; Pavel Büchler; Sophie Bueno-Boutellier; Angela Bulloch; Nicholas Byrne; Varda Caivano; Patrick Caulfield; Juliana Cerqueira Leite; Alice Channer; Billy Childish; Adam Chodzko; Steven Claydon; Jason Coburn; Brett Cody Rogers;

The approach

Matthew Collings; George Condo; Bruce Conner; Angus Cook; Nigel Cooke; Chris Coombes; Dan Coombs; Keith Coventry; Martin Creed; Russell Crotty; Juan Cruz; Stuart Cumberland; Leigh Curtis; Jacob Dahl Jürgensen; Salvador Dali; René Daniels; David David; Enrico David; Peter Davies; Verne Dawson; Aletta de Jong; Tacita Dean; Sonia Delaunay; Jeremy Deller; Nicolas Deshayes; Naomi Dines; Harry Dodge; Kaye Donachie; Peter Dreher; Dubbossarsky & Vinogradov; Raoul Dufy; Sean Edwards; Laura Elmsley; Geraint Evans; Tanya Fairey; Keith Farquhar; Dee Ferris; Festival Pattern Group; Peter Fillingham; Barry Flannagan; Simon Foster-Ogg; Christopher Garrett; Ana Genovés; Lotte Gertz; Gilbert & George; Liam Gillick; Steven Gontarski; Felix Gonzalez-Torres; Andrew Grassie; Michael Hakimi; Anthea Hamilton; Richard Hamilton; Charlie Hammond; Sebastian Hammwöhner; Freya Hansell; Lucy Harrison; Robert Heinecken; Thomas Helbig; Stewart Helm; Nigel Henderson; Uwe Henneken; Lucy Heyward; Patrick Hill; Clive Hodgson; Evan Holloway; Stewart Home; Paul Housley; Douglas Huebler; David Hughes; Dean Hughes; Tom Humphreys; Inventory; Jo Jackson; Danni Jakob; Merlin James; Sergej Jensen; Chris Johanson; Gareth Jones; Hans Peter Josephson; Ben Judd; Isaac Julian; Johanners Kahrs; Allison Katz; Emma Kay; Mike Kelley; Kevin Knox; Lucia Koch; Kiki Kogelnik; Frank Koolen; Udamsak Krisanamis; Germaine Kruip; Lisa Lapinski; Ruth Laskey; Jack Lavender; Mark Leckey; Hannah Lees; Arnold Lever; Alexandra Leykauf; Edward Lipski; Maria Loboda; Colin Lowe; Rachel Lowe; Rachel Lowther; Dietmar Lutz; Bill Lynch; Euan MacDonald; Christina Mackie; Alastair MacKinven; Paul Maheke; Antje Majewski; Robert Mapplethorpe; Alisa Margolis; Alexis Marguerite Teplin; Karl Maughan; Dora Maurer; James Clark Maxwell; Charles Mayton; Martin McGeown; Keegan McHargue; Jason Meadows; David Medalla; Anne Michie; Alan Miller; J P Monro; Henry Moore; Ree Morton; Carter Mull; Dave Muller; Takeshi Murata; Scott Myles; Adam Nankervis; Ben Nicholson; Jacques Nimki; Paul Noble; Chris Ofili; B. Ingrid Olson; Lisa Oppenheim; Oliver Osborne; Eduardo Paolozzi; Jayne Parker; Simon Patterson; Celia Paul; Mitzi Pederson; Jenny Perlin; Francis Picabia; Pablo Picasso; Falke Pisano; Alex Pollard; Josephine Pryde; Puppies Puppies; Florian Pumhösl; James Pyman; Michael Raedecker; Magali Reus; Mandla Reuter; Anselm Reyle; Audrey Reynolds; Bridget Riley; Florian Roithmayr; Kay Rosen; Amanda Ross-Ho; Eva Rothschild; Giles Round; Alun Rowlands; Giorgio Sadotti; Zilia Sánchez; Elizabeth Saveri; Matthew Sawyer; Thomas Scheibitz; Nora Schultz; Richard Serra; Paul Sharits; George Shaw; Peter Shelton; Erin Shirreff; Thomas Schütte; Daniel Silver; Jane Simpson; Daniel Sinsel; Bob & Roberta Smith; Smith/Stewart; Harry Smith; Johnny Spencer; Humphry Spender; Lucy Stein; Kerry Stewart; John Stezaker; Lily van der Stokker; Tim Stoner; Simon Streather; Daniel Sturgis; Mari Sunna; Graham Sutherland; Walter Swennen; Neal Tait; Evren Tekinoktay; David Thorp; Caragh Thuring; Mark Titchner; Hayley Tompkins; Amikam Toren; Armando Andrade Tudela; Keith Tyson; Nicholas Usansky; Sara VanDerBeek; Geerten Verheus; Ana Viera; Edward Wadsworth; Kara Walker; Chris Warmington; Rebecca Warren; Gillian Wearing & Michael Landy; Gary Webb; Andro Wekua; Martin Westwood; Holly White; Tony White; John Wilkins; Stephen Willats; John Williams; Sam Windett; Alexander Wolff; Claire Woods; Tom Wood; Rose Wylie; Cerith Wyn Evans; Shizuka Yokomizo.

The approach

20 Years Show
6 July – 6 August 2017

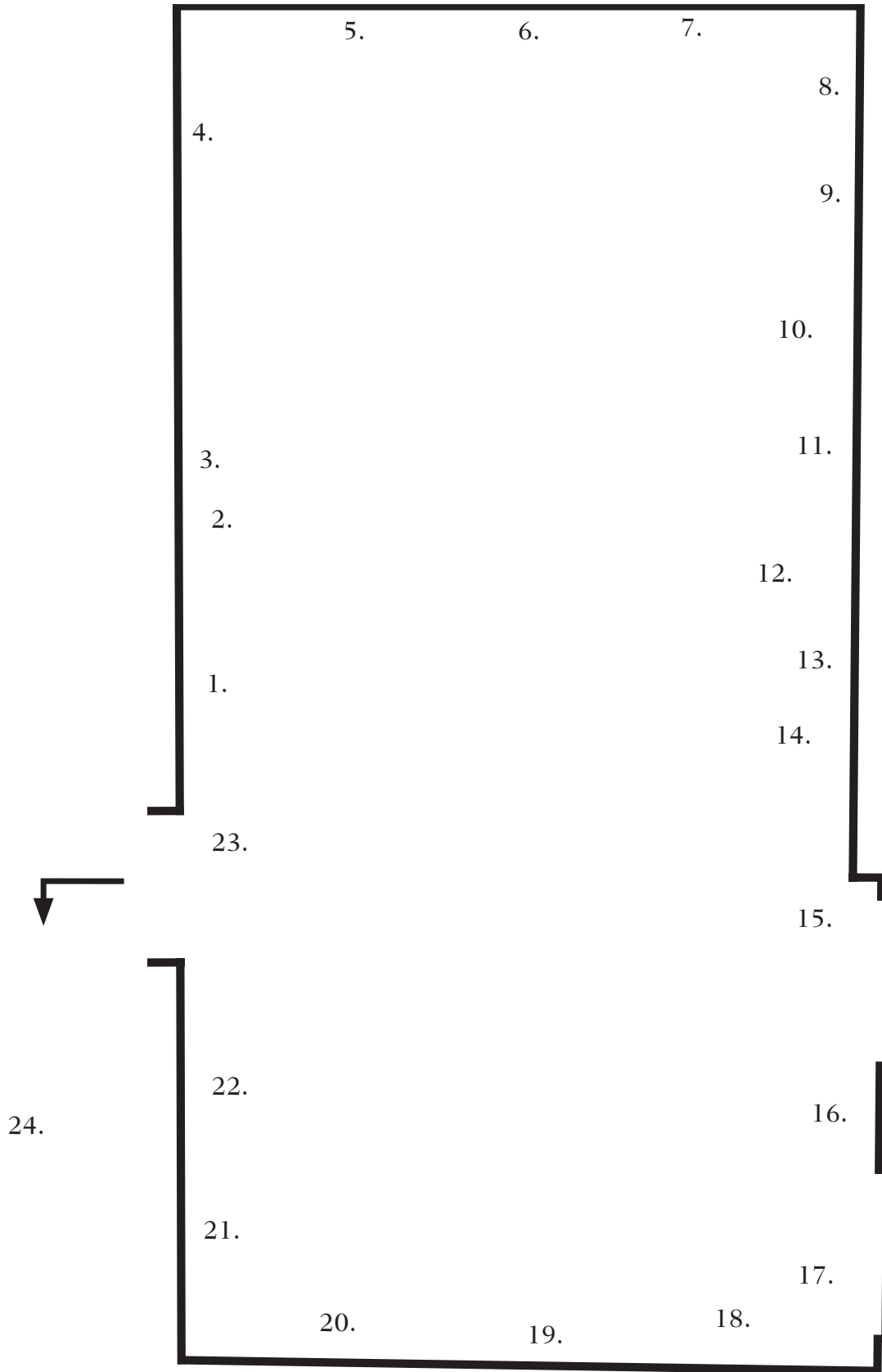

The approach

20 Years Show

6 July – 6 August 2017

- 1. Evren Tekinoktay**
The Village, 2016
Quilt on mirror
117 x 117 x 4 cm | 46 x 46 x 1 1/2 in.
- 2. Jack Lavender**
No title, 2017
Pigment on glass
Variable dimensions
- 3. Peter Davies**
Idiom, 2017
Acrylic on canvas
213.5 x 167.5 cm | 84 x 65 7/8 in.
- 4. Sophie Bueno-Boutellier**
Light and Will, 2016
Acrylic on canvas
110 x 70 x 19 cm | 43 1/4 x 27 1/2 x 7 3/8 in.
- 5. Sara Barker**
a child slipping
a man losing his hat
in the natural weather, 2017
Jesmonite, automotive paint, stainless steel rod
99 x 134 x 27 cm | 39 x 52 3/4 x 10 5/8 in.
Panel: 66 x 81 cm | 26 x 31 7/8 in
- 6. Helene Appel**
Carp Slice, 2017
Encaustic and oil on linen
17.9 x 9.7 cm | 7 x 3 3/4 in.
- 7. Lisa Oppenheim**
Landscape Portraits (Cherry) (Version III), 2016
Set of two silver gelatin prints in Cherry frames, diptych
61 x 61 cm | 24 x 24 in.
Each part: 61 x 61 cm | 24 x 24 in.
- 8. John Stezaker**
Psychomontage (Kiss), 1976
Collage
66.2 x 51.1 cm | 26 1/16 x 20 1/16 in.
- 9. Sam Windett**
Vertical Shift, 2016
Oil, house paint and collage on linen
180 x 102 cm | 70 3/4 x 40 1/8 in.
- 10. Evan Holloway**
Two Maps, 2017
Bronze, oil enamel
36.8 x 40.6 x 27.9 cm | 14 1/2 x 16 x 11 in.
- 11. Bill Lynch**
No title [Silver Dollar Branches], n.d.
Oil on wood
121.9 x 76.2 cm | 48 x 30 in.
- 12. Patrick Hill**
Untitled, 2016
Wood, marble, stainless steel, rice paper dye, ink, glue
91.4 x 61 x 15.2 cm | 36 x 24 x 6 in.
- 13. Amanda Ross-Ho**
Untitled Timepiece, 2016
Graphite and gouache on found clock face
33 x 33 cm | 13 x 13 in.
- 14. Phil Allen**
Mr Please Please (I never predict anything and I never will version), 2017
Oil on board, 40 x 36 cm | 15 5/8 x 14 1/8 in.
- 15. Allison Katz**
Arsi/Versi, 2016
Ceramic
21.5 x 18 x 18 cm | 8 3/4 x 7 x 7 in.
- 16. Rezi van Lankveld**
Roots, 2017
Oil on canvas
65 x 58 cm | 25 1/2 x 22 3/4 in.
- 17. Germaine Kruij**
Rhombus, 2017
Edition of 10 + 1 AP
Polished brass
45 x 15 cm | 17 5/8 x 5 7/8 in.
- 18. Dave Muller**
Self Portrait at Jake's (Yesterday and Today), 2013
acrylic on paper
203.2 x 152.4 cm | 80 x 60 in.
- 19. Gary Webb**
Gobi, 2017
Resin, marble, car paint, mirror-polished aluminium
63 x 92.5 x 27 cm | 24 3/4 x 36 3/8 x 10 5/8 in.
Unique in a series
- 20. Heidi Bucher**
Destiladera Roja, 1991
Latex on canvas
217 x 82 cm | 85 3/8 x 32 1/4 in.
- 21. Sara VanDerBeek**
VI (from the series Ventura), 2015
Edition of 3
6 digital C-prints, Diptych
Framed dimensions (each):
51.9 x 39.8 cm | 20 7/16 x 15 11/16 in.
- 22. Magali Reus**
Leaves (Harp, January), 2015
Milled and sprayed model board, aluminium tube, silicone rubber, pigments, powder coated, zinc plated, blackened etched and anodized laser cut aluminium and steel, bolts
61 x 42 x 15 cm | 24 x 16 1/2 x 5 7/8 in.
- 23. Stuart Cumberland**
Cable Release, 2014
Oil on linen
55 x 46 cm | 21 5/8 x 18 1/16 in.
- 24. Patrick Caulfield**
Pipe & Blind, 1990
Acrylic on canvas
76.2 x 61 cm | 30 x 24 in.